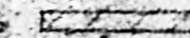
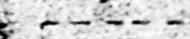

ARCHITECTURAL WING I  
INDIAN POSTS AND TELEGRAPHS DEPARTMENT

- NOTES
- THIS LAYOUT PLAN HAS BEEN TRACED FROM DRG. NO. RAS/854
  - PROPOSED WORK SHOWN THUS 
  - EXISTING BLDGS SHOWN THUS 
  - WORKS FOR FUTURE SHOWN THUS 

THE PROPOSED M.W. TOWER SHALL BE CONSTRUCTED ON ONE FLOOR FOR THE I.P.T. BLDG. REF. DRG. NO. 107 OF 1951 SAM 3/5

FOR TYPE II JOB REFER DRG. NO. 107 OF 1951 SAM 3/5

W. ALSO DRG. NO. 107 OF 1951 SAM 3/5

CYCLE ROPS. DELIVERED AS PER MINISTRY OF WORKS AND INDUSTRIES O.M. NO. 17020/1/57 - W<sub>2</sub> DT. 30-3-58

THE EXISTING CHANGI & LAMP HOUSE STRUCTURE WITH 230 MM THICK BRICK WALLS



Planning Clearance No. C.H. 26/89

**APPROVED**

Subject to the conditions in this office letter

No. C/3468/89 Dt. 3.11.89

*[Signature]*

FOR MEMBER SECRETARY  
MADRAS METROPOLITAN  
DEVELOPMENT AUTHORITY

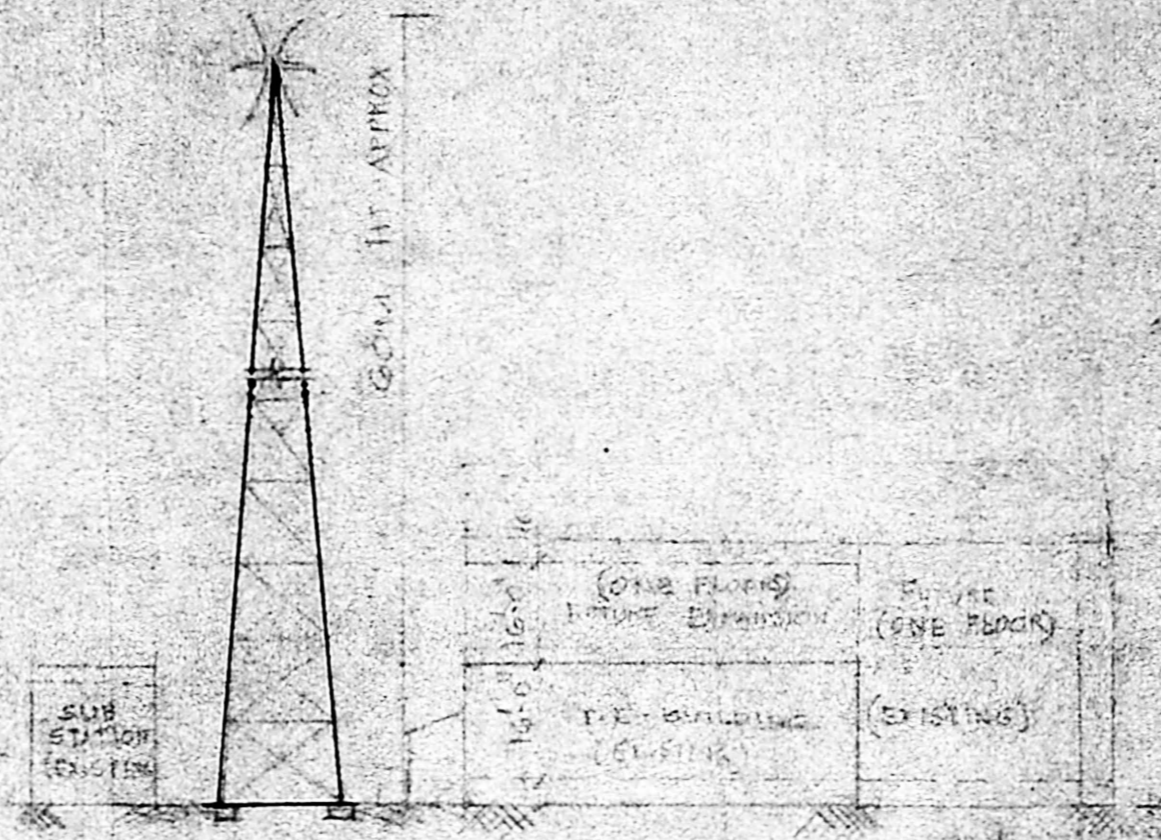

M.W. TOWER IN ELEVATION

THREE REDUCED

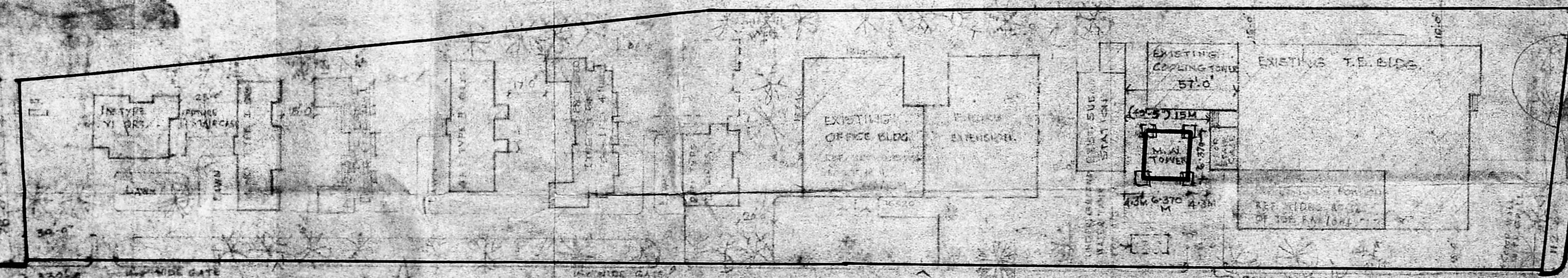

REVISIONS

NO. 1. THE PROPOSED M.W. TOWER SHALL BE CONSTRUCTED ON ONE FLOOR FOR THE I.P.T. BLDG. REF. DRG. NO. 107 OF 1951 SAM 3/5

NO. 2. FOR TYPE II JOB REFER DRG. NO. 107 OF 1951 SAM 3/5

NO. 3. W. ALSO DRG. NO. 107 OF 1951 SAM 3/5

NO. 4. CYCLE ROPS. DELIVERED AS PER MINISTRY OF WORKS AND INDUSTRIES O.M. NO. 17020/1/57 - W<sub>2</sub> DT. 30-3-58

NO. 5. THE EXISTING CHANGI & LAMP HOUSE STRUCTURE WITH 230 MM THICK BRICK WALLS

DATE: 11.11.89

*[Signature]*

Asst. Genl. Manager (Buildings)  
Madras Telephones

REGIONAL ARCHITECTS

JOB NO. RAS/854

SCALE 1/250

DRG. NO. 60

DATE: 11.11.89

CONST. OF OFFICE BLDG. OF EXTERNAL UNIT AT AVADI (MADRAS)

LAYOUT PLAN